

# FLAT D3 | 3B 2T

Available in Tower E

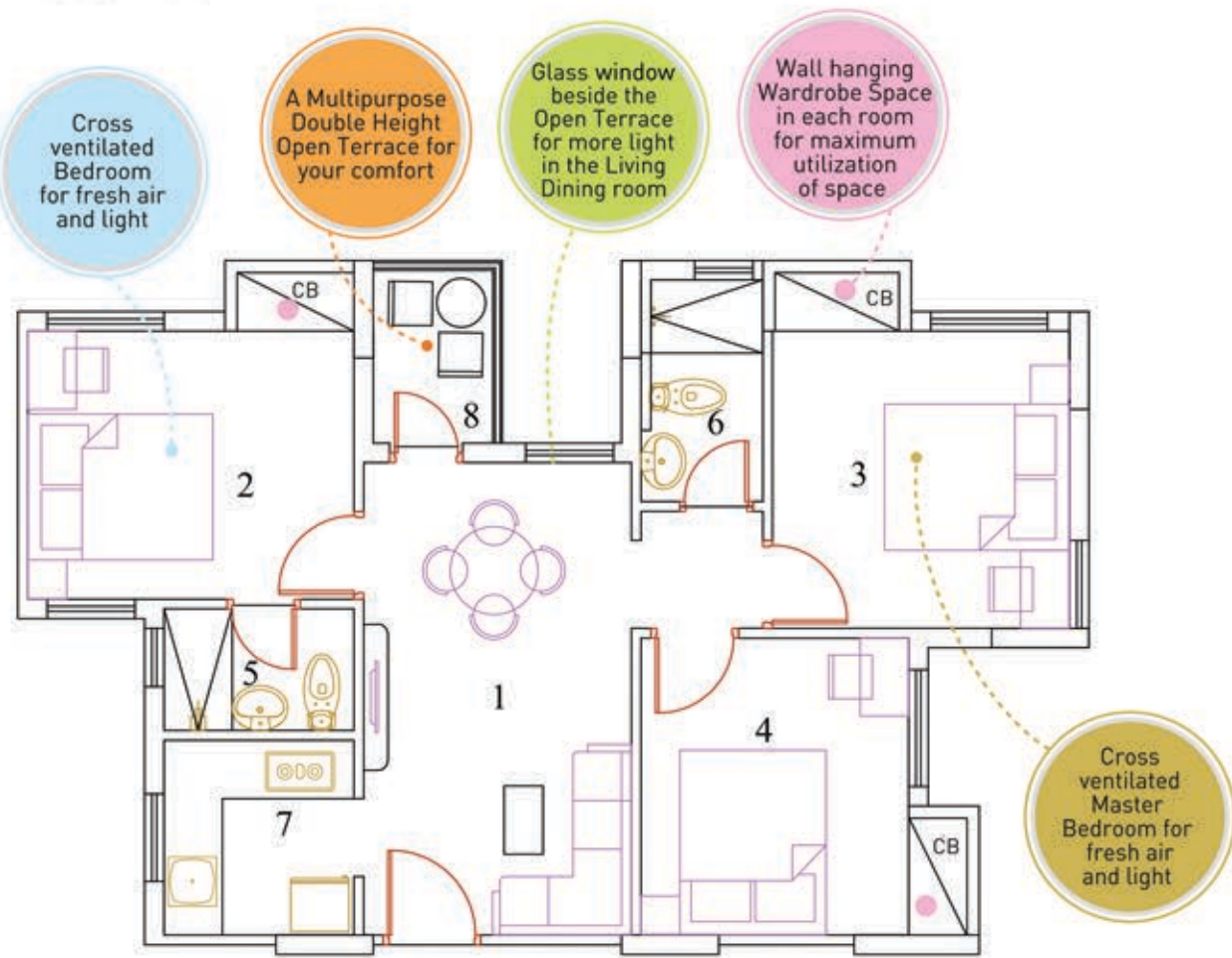

**Carpet area** 594 sq.ft.  
**Carpet Area + Balcony** 620 sq.ft.  
**Built up area** 689 sq.ft.  
**Standard built up area** 955 sq.ft.

1	Living/Dining	15'11"x9'0"
2	Bedroom	11'0"x11'0" (11'0"x9'0" without CB)
3	Bedroom	12'0"x10'0" (10'0"x10'0" without CB)
4	Bedroom	11'0"x10'0" (9'0"x10'0" without CB)
5	Toilet	6'5"x4'1"
6	Toilet	7'6"x4'1"
7	Kitchen	6'5"x6'7"
8	Open terrace	6'2"x4'4"